

mit Heizwendelschale für PE - HD - Rohre PN 4 / PN 10

ø d 63 – d 225; mit horizontalem ZAK® - Abgang 90° zur Rohrriichtung

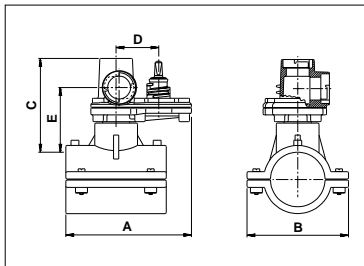

Technische Merkmale:

- Material: Hawlingergehäuse (Ober - und Unterteil): GGG - 40
 Dichtungen: NBR - gasfest nach DIN 3535 Teil 3
- Druckstufe: Wasser: 16 bar, Gas: 4 bar

| Best.-Nr. | Ausführung | Rohr - ø mm | A mm | B mm | C mm | D mm | E mm | Bohrungs-ø max. mm | Gewicht kg |
|-----------|------------|----------------|---------|---------|---------|---------|---------|-----------------------|---------------|
| 239 063 U | ZAK 34 | 63 | 170 | 105 | 90 | 68 | 105 | 25 | 4,10 |
| 239 090 U | ZAK 34 | 90 | 200 | 160 | 95 | 68 | 115 | 25 | 6,20 |
| 239 110 U | ZAK 34 | 110 | 215 | 170 | 95 | 68 | 115 | 25 | 6,30 |
| 239 125 U | ZAK 34 | 125 | 215 | 190 | 110 | 68 | 125 | 25 | 6,50 |
| 239 160 U | ZAK 34 | 160 | 220 | 230 | 110 | 68 | 120 | 25 | 6,90 |
| 239 180 U | ZAK 34 | 180 | 220 | 245 | 110 | 68 | 120 | 25 | 7,10 |
| 239 200 U | ZAK 34 | 200 | 220 | 250 | 110 | 68 | 120 | 25 | 7,30 |
| 239 225 U | ZAK 34 | 225 | 220 | 255 | 100 | 68 | 120 | 25 | 7,40 |
| 239 250 U | ZAK 34 | 250 | 245 | 205 | 100 | 68 | 120 | 25 | 7,80 |
| 239 280 U | ZAK 34 | 280 | 245 | 205 | 100 | 68 | 120 | 25 | 7,80 |
| 239 315 U | ZAK 34 | 315 | 245 | 205 | 100 | 68 | 120 | 25 | 8,00 |
| 239 090 U | ZAK 46 | 90 | 200 | 160 | 95 | 82 | 115 | 35 | 8,40 |
| 239 110 U | ZAK 46 | 110 | 215 | 170 | 95 | 82 | 115 | 35 | 8,50 |
| 239 125 U | ZAK 46 | 125 | 215 | 190 | 110 | 82 | 125 | 35 | 8,70 |
| 239 160 U | ZAK 46 | 160 | 220 | 230 | 110 | 82 | 120 | 35 | 9,00 |
| 239 180 U | ZAK 46 | 180 | 220 | 245 | 110 | 82 | 120 | 35 | 9,20 |
| 239 200 U | ZAK 46 | 200 | 220 | 250 | 110 | 82 | 120 | 35 | 9,40 |
| 239 225 U | ZAK 46 | 225 | 220 | 255 | 100 | 82 | 120 | 35 | 9,50 |
| 239 250 U | ZAK 46 | 250 | 245 | 205 | 100 | 82 | 120 | 35 | 9,90 |
| 239 280 U | ZAK 46 | 280 | 245 | 205 | 100 | 82 | 120 | 35 | 9,90 |
| 239 315 U | ZAK 46 | 315 | 245 | 205 | 100 | 82 | 120 | 35 | 10,10 |